

ICC AUDITORIUM

LEVEL 0

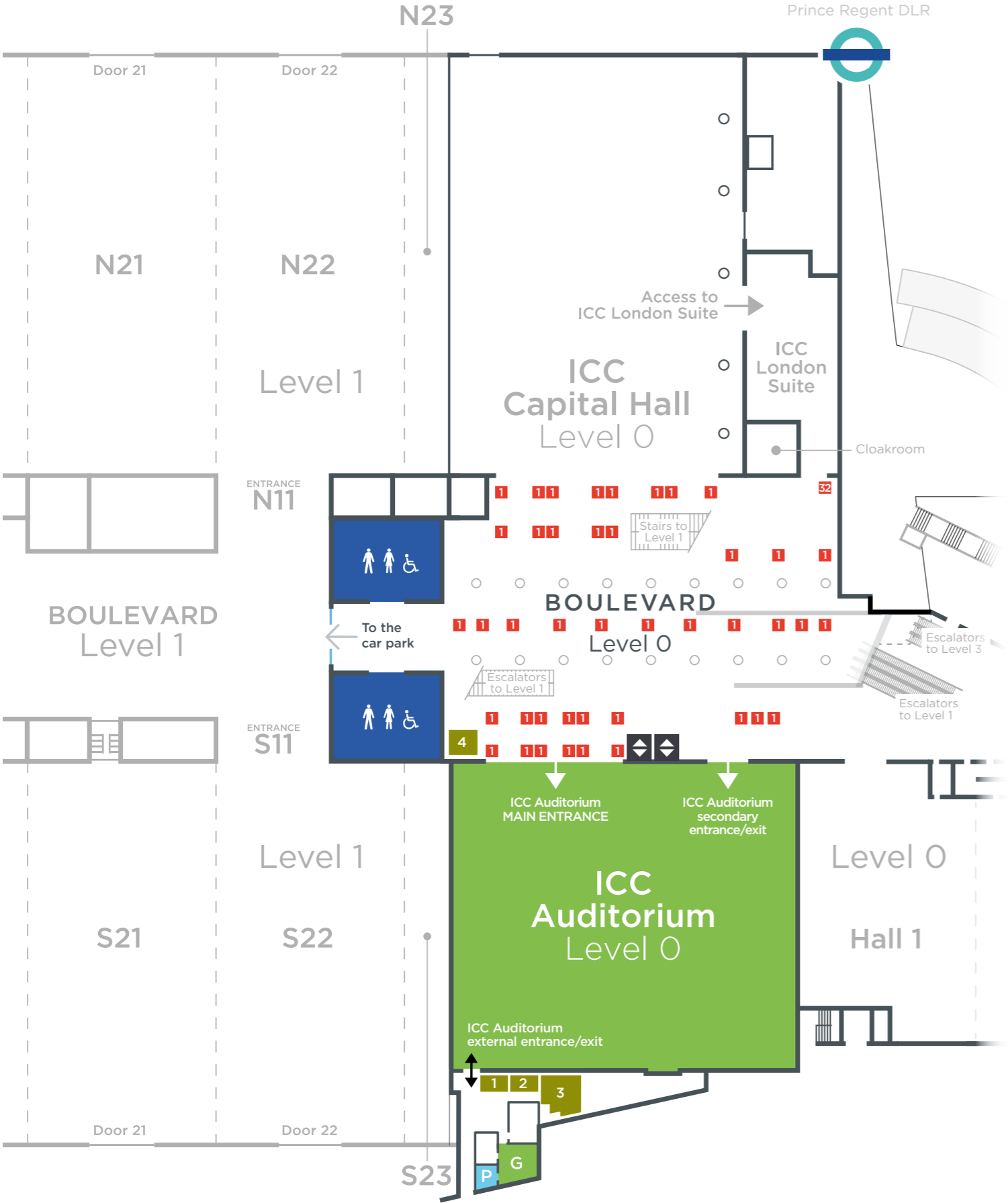

Floor plan examples



Locator map

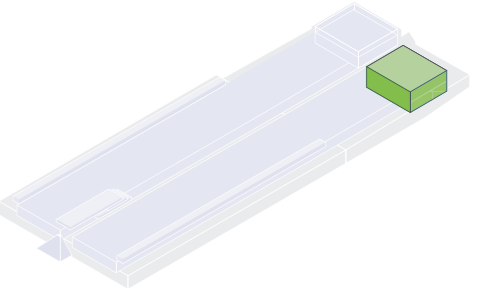

Key features

- Seating for up to 4,200 delegates
- 4,603m² space
- 72.67m (l) x 63.34m (w) x 15.0m (h)
- Acoustic panelling
- 7.2m wide drive-in doorways
- Floor weight loading: 18 kN/m²
- Permanent cabling including IT, electric, water, waste, compressed air, gas
 - Serviced by underfloor ducts every 5.0m North to South and 3.0m East to West
- Auditorium backstage rooms:
 - Green room: 8.7m x 8m, 61.5m² total. Including furniture, phone, plasma screen, service pantry, toilets and shower
 - Organiser office 1: 2.2m x 6.3m, 13.7m² total
 - Organiser office 2: 2.2m x 6.4m, 14m² total
 - Organiser office 3: 8.0m x 8.0m, 64m² total
 - Organiser office 4: 4.0m x 4.7m, 18.8m² total
- AV and stage included
- Easy access to and from ICC Capital Hall
- Boulevard: 1,705m²

Key

- 1** Floor box type 1
 - 2x 13 AMP sockets
 - 4x jack plugs
- 32** 32 AMP single phase supply
- O** Organiser offices
- P** Pantry
- G** Green room
- Columns
- Toilets**
 - ♂** Male
 - ♀** Female
 - ♿** Accessible
- ⬆** Public lifts
- Tiered seating
- Flat floor seating
- }** Drape